

2360 Boswell Road
Chula Vista, CA 91914
Phone 619.216.1444
Fax 619.216.1474
E-Mail tech@explorerprocomp.com



PRO COMP SUSPENSION

Suspension Systems that Work!

**Light Bar Kit PN
21000, 21200, 21300
1999 - 2002 GMC / Chevrolet
HD 1/2 / 3/4 ton 2 X 4 & 4 X 4**

This document contains very important information that includes warranty information and instructions for resolving problems you may encounter. Please keep it in the vehicle as a permanent record.

- ◆ This installation requires a professional mechanic!
- ◆ We recommend that you have access to a GM service manual for your vehicle to assist in the disassembly and reassembly of your vehicle. It contains a wealth of detailed information.
- ◆ Prior to installation, carefully inspect the vehicle's steering and driveline systems paying close attention to the tie rod ends, ball joints, wheel bearing preload, pitman and idler arm. Additionally, check steering-to-frame and suspension-to-frame attaching points for stress cracks. The overall vehicle must be in excellent working condition. Repair or replace all worn or damaged parts!
- ◆ Read the instructions carefully and study the illustrations before attempting installation! You may save yourself a lot of extra work.
- ◆ Check the parts and hardware against the parts list to assure that your kit is complete. Separating parts according to the areas where they will be used and placing the hardware with the brackets before you begin will save installation time.
- ◆ Check the special equipment list and ensure the availability of these tools.
- ◆ Secure and properly block vehicle prior to beginning installation.
- ◆ ALWAYS wear safety glasses when using power tools or working under the vehicle!
- ◆ Use caution when cutting is required under the vehicle. The factory undercoating is flammable. Take appropriate precautions. Have a fire extinguisher close at hand.
- ◆ Foot pound torque readings are listed on the Torque Specifications chart at the end of the instructions. These are to be used unless specifically directed otherwise. Apply thread lock-retaining compound where specified.
- ◆ *Please note that while every effort is made to ensure that the installation of your Pro Comp lift kit is a positive experience, variations in construction and assembly in the vehicle manufacturing process will virtually ensure that some parts may seem difficult to install. Additionally, the current trend in manufacturing of vehicles results in a frame that is highly flexible and may shift slightly on disassembly prior to installation. The use of pry bars and tapered punches for alignment is considered normal and usually does not indicate a faulty product. However, if you are uncertain about some aspect of the installation process, please feel free to call our tech support department at the number listed on the cover page. We do not recommend that you modify the Pro Comp parts in any way as this will void any warranty expressed or implied by the Pro Comp Suspension company.*

This document contains important information that includes warranty information and instructions for resolving problems you may encounter. Please keep it in the vehicle as a permanent record.

Parts

Part #	Description	Quantity	Illustration
90-2232	LIGHT BAR, (WITH KIT 21200)	1	1
	<u>OR</u>		
90-2240	LIGHT BAR, (WITH KIT 21000)	1	1
	<u>OR</u>		
90-2259	LIGHT BAR, (WITH KIT 21300)	1	1
	<u>AND</u>		
90-6205	LIGHT BAR HARDWARE PACK	1	
70-0501501800	1/2" X 1 1/2" GRADE 8 HEX BOLT	2	1
70-0503751800	1/2" X 3 3/4" GRADE 8 HEX BOLT	2	1
73-05000034	1/2" SAE GRADE 8 FLAT WASHER	8	1
72-05000100816	1/2" TOP LOCK NUT	4	1
90-6206	LIGHT BAR PLASTIC CAP PACK	1	
15-11213	PLASTIC CAPS	2	1
90-2239	1" X 2 1/2" SPACERS	2	1
90-2025	1" X 1" SPACERS	2	1

INSTALLATION INSTRUCTIONS

1. Carefully remove the grill from the front of your truck. There are Phillips head screws at the top of the grill and 1/4 turn quick release fasteners at the bottom.
2. Loosely assemble the light bar (**90-2232 or 90-2240**), **1/2" X 3 3/4" bolts**, and spacers (**90-2239, 90-2025**) onto the truck bumper as shown in **ILLUSTRATION 1**. This kit uses two existing holes just behind the plastic fascia at the top of the bumper for the top braces and bolts. Included in the kit are two lengths of spacers to allow for the proper mounting of the light bar. A combination of one long and one short spacer must be used to accommodate the bolt length. The placement of the long spacer above the bumper tab **or** the short spacer above the bumper tab will vary between GMC and Chevrolet. The proper combination of spacers will place the light bar mount tab *just above* the upper bumper surface. Both spacers are needed to keep the bolt threads from binding. Snug up the bolts at this time.
Note: There are several styles of bumpers from GM. For the next step, choose a feature that is horizontal to the ground on the bumper that can be used on both sides of the vehicle for a common reference point for measurements.
3. Note the position of the end mount holes of the light bar in relation to the bumper. Carefully measure down from the previously noted feature of the bumper to the center of the light bar mount sockets. You may have to twist the assembly slightly to achieve the same dimension on both ends. Mark the location of the mounting holes.
4. Check behind the bumper at these locations to ensure there are no vital components in the way before drilling the mounting holes.

5. Remove the light bar from the truck, carefully center punch the centers of the holes and drill the holes with a 1/2" drill bit.
6. Reinstall the light bar to the frame, repeating **step 2**. Install the 1/2" X 1 1/2" bolts supplied through the front mounts and torque *all* fasteners to 60 ft. lbs.
7. Install the plastic plugs (15-11213) into the ends of the light bar.
8. Reinstall your grill.
9. You are now ready to install the lights of your choice. Pro Comp Suspension has a complete line of lights available for use. Contact your local sales representative for additional information.

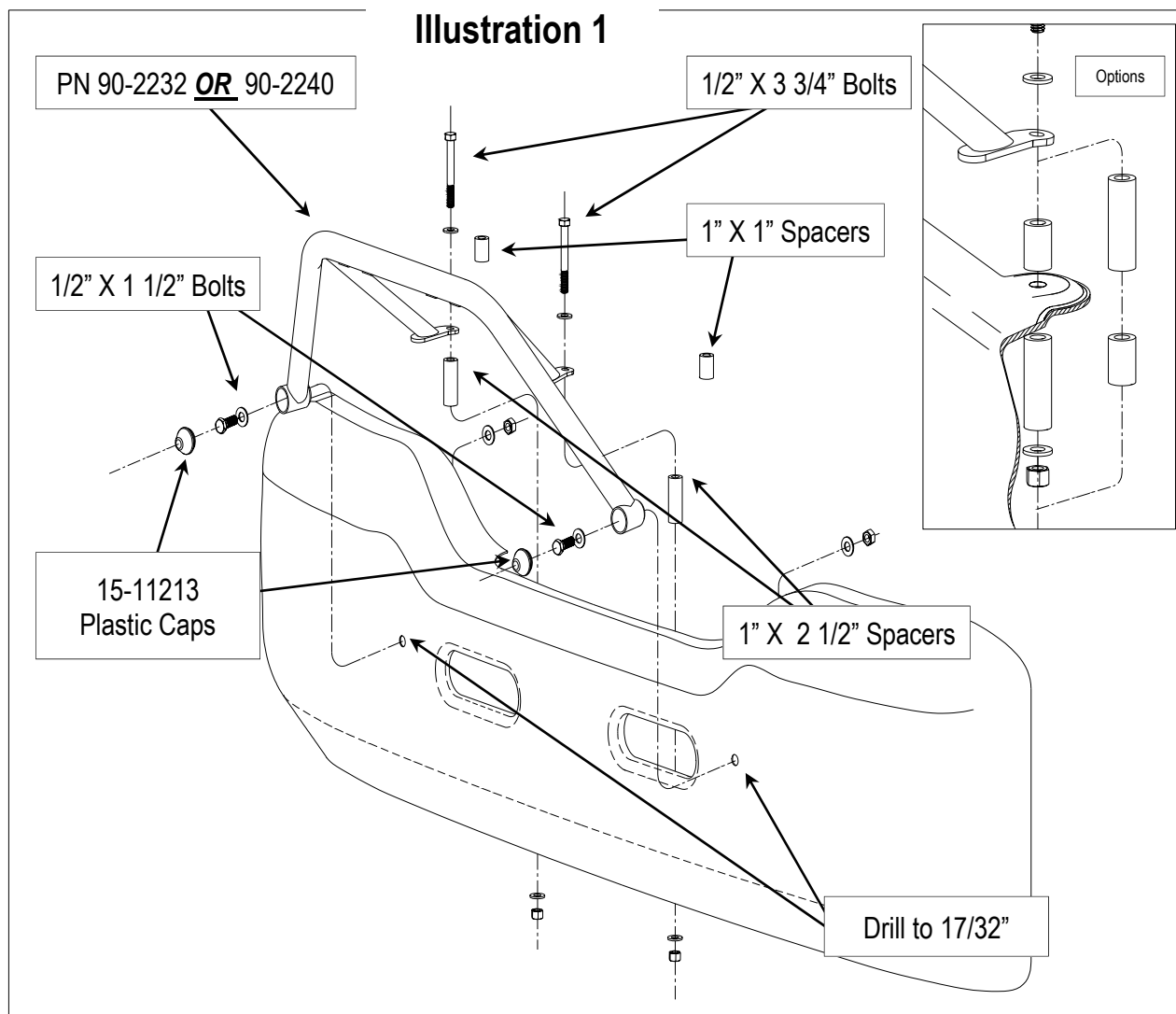

Use this only as a guide for hardware without a called out torque specification in the instruction manual.

Bolt Torque and ID							
Decimal System				Metric System			
All Torques in Ft. Lbs. Maximums							
Bolt Size	Grade 5	Grade 8	Bolt Size	Class 9.8	Class 10.9	Class 12.9	
5/16	15	20	M6	5	9	12	
3/8	30	45	M8	18	23	27	
7/16	45	60	M10	32	45	50	
1/2	65	90	M12	55	75	90	
9/16	95	130	M14	85	120	145	
5/8	135	175	M16	130	165	210	
3/4	185	280	M18	170	240	290	

1/2-13x1.75 HHCS

Grade 5 Grade 8
(No. of Marks + 2)

D T L X

G = Grade (Bolt Strength)
D = Nominal Diameter (Inches)
T = Thread Count (Threads per Inch)
L = Length (Inches)
X = Description (Hex Head Cap Screw)

M12-1.25x50 HHCS

P

D T L X

P = Property Class (Bolt Strength)
D = Nominal Diameter (Millimeters)
T = Thread Pitch (Thread Width, mm)
L = Length (Millimeters)
X = Description (Hex Head Cap Screw)

Notice to Owner operator, Dealer and Installer:

Vehicles that have been enhanced for off-road performance often have unique handling characteristics due to the higher center of gravity and larger tires. This vehicle may handle, react and stop differently than many passenger cars or unmodified vehicles, both on and off-road. You must drive your vehicle safely! Extreme care should always be taken to prevent vehicle rollover or loss of control, which can result in serious injury or even death. Always avoid sudden sharp turns or abrupt maneuvers and allow more time and distance for braking! Pro Comp reminds you to fasten your seat belts at all times and reduce speed! We will gladly answer any questions concerning the design, function, maintenance and correct use of our products.

Please make sure your Dealer/Installer explains and delivers all warning notices, warranty forms and instruction sheets included with Pro Comp product.

Application listings in this catalog have been carefully fit checked for each model and year denoted. However, Pro Comp reserves the right to update as necessary, without notice, and will not be held responsible for misprints, changes or variations made by vehicle manufacturers. Please call when in question regarding new model year, vehicles not listed by specific body or chassis styles or vehicles not originally distributed in the USA.

Please note that certain mechanical aspects of any suspension lift product may accelerate ordinary wear of original equipment components. Further, installation of certain Pro Comp products may void the vehicle's factory warranty as it pertains to certain covered parts; it is the consumer's responsibility to check with their local dealer for warranty coverage before installation of the lift.

Warranty and Return policy:

Pro Comp warrants its full line of products to be free from defects in workmanship and materials. Pro Comp's obligation under this warranty is limited to repair or replacement, at Pro Comp's option, of the defective product. Any and all costs of removal, installation, freight or incidental or consequential damages are expressly excluded from this warranty. Pro Comp is not responsible for damages and / or warranty of other vehicle parts related or non-related to the installation of Pro Comp product. A consumer who makes the decision to modify his vehicle with aftermarket components of any kind will assume all risk and responsibility for potential damages incurred as a result of their chosen modifications. Warranty coverage does not include consumer opinions regarding ride comfort, fitment and design. Warranty claims can be made directly with Pro Comp or at any factory authorized Pro Comp dealer.

IMPORTANT! To validate the warranty on this purchase please be sure to mail in the warranty card.

Claims not covered under warranty-

- Parts subject to normal wear, this includes bushings, bump stops, ball joints, tie rod ends and heim joints
 - Discontinued products at Pro Comp's discretion
- Bent or dented product
- Finish after 90 days
- Leaf or coil springs used without proper bump stops
- Light bulbs
- Products with evident damage caused by abrasion or contact with other items
- Damage caused as a result of not following recommendations or requirements called out in the installation manuals
- Products used in applications other than listed in Pro Comp's catalog
- Components or accessories used in conjunction with other manufacturer's systems
- Tire & Wheel Warranty as per Pro Competition Tire Company policy
- Warranty claims without "Proof of Purchase"
- Pro Comp Pro Runner coil over shocks are considered a serviceable shock with a one-year warranty against leakage only. Rebuild service and replacement parts will be available and sold separately by Pro Comp. Contact Pro Comp for specific service charges.
- Pro Comp accepts no responsibility for any altered product, improper installation, lack of or improper maintenance, or improper use of our products.

E-Mail: tech@explorerprocomp.com
Website: www.explorerprocomp.com
Fax: (619) 216-1474
Ph: (619) 216-1444

PLACE
WARRANTY REGISTRATION
NUMBER
HERE: _____